

## Valve Cover — LH

### Material

Item	Specification
Motorcraft® Metal Surface Prep ZC-31-A	—
Silicone Gasket and Sealant TA-30	WSE-M4G323-A4
Silicone Gasket Remover ZC-30	—

### LH Valve Cover (View 1 of 2)

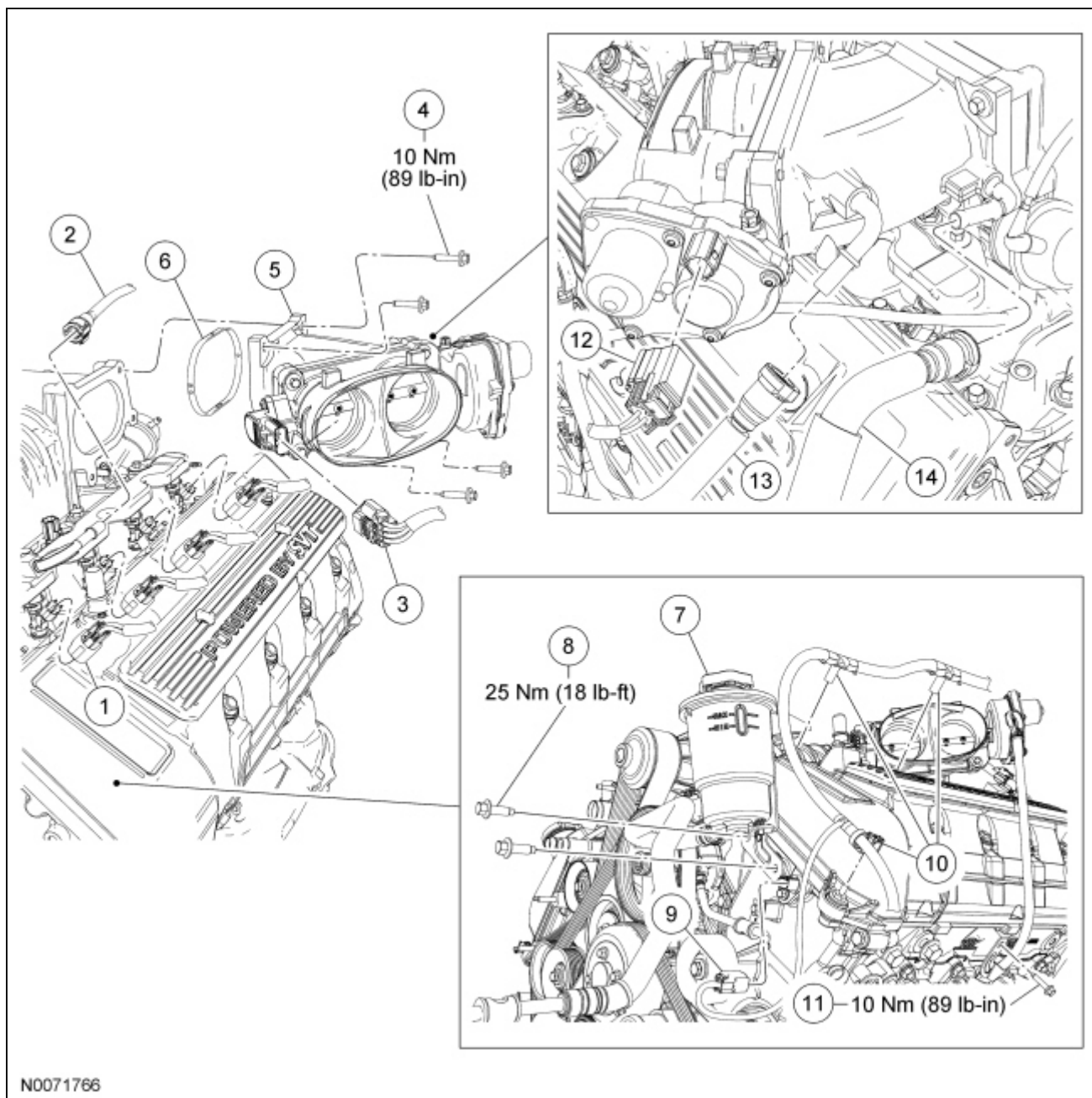

Item	Part Number	Description
1	14A464	LH fuel injector electrical connector (4 required) (part of 12B637)
2	9J280	Fuel supply tube
3	14A464	Throttle Position (TP) sensor electrical connector (part of 12B637)
4	N806154	Throttle Body (TB) spacer bolt (4 required)
5	9E822	<u>TB</u> and spacer
6	9L437	<u>TB</u> spacer gasket
7	3R700	Power steering reservoir
8	W500223	Power steering reservoir bolt (2 required)
9	14A464	Camshaft Position (CMP) sensor electrical connector (part of 12B637)
10	—	Wiring harness retainers (3 required) (part of 12B637)
11	N806155	Oil level indicator tube bolt
12	14A464	Electronic throttle control electrical connector (part of 12B637)
13	9G271	Evaporative Emission (EVAP) hose
14	2B432	Brake booster vacuum hose

#### LH Valve Cover (View 2 of 2)

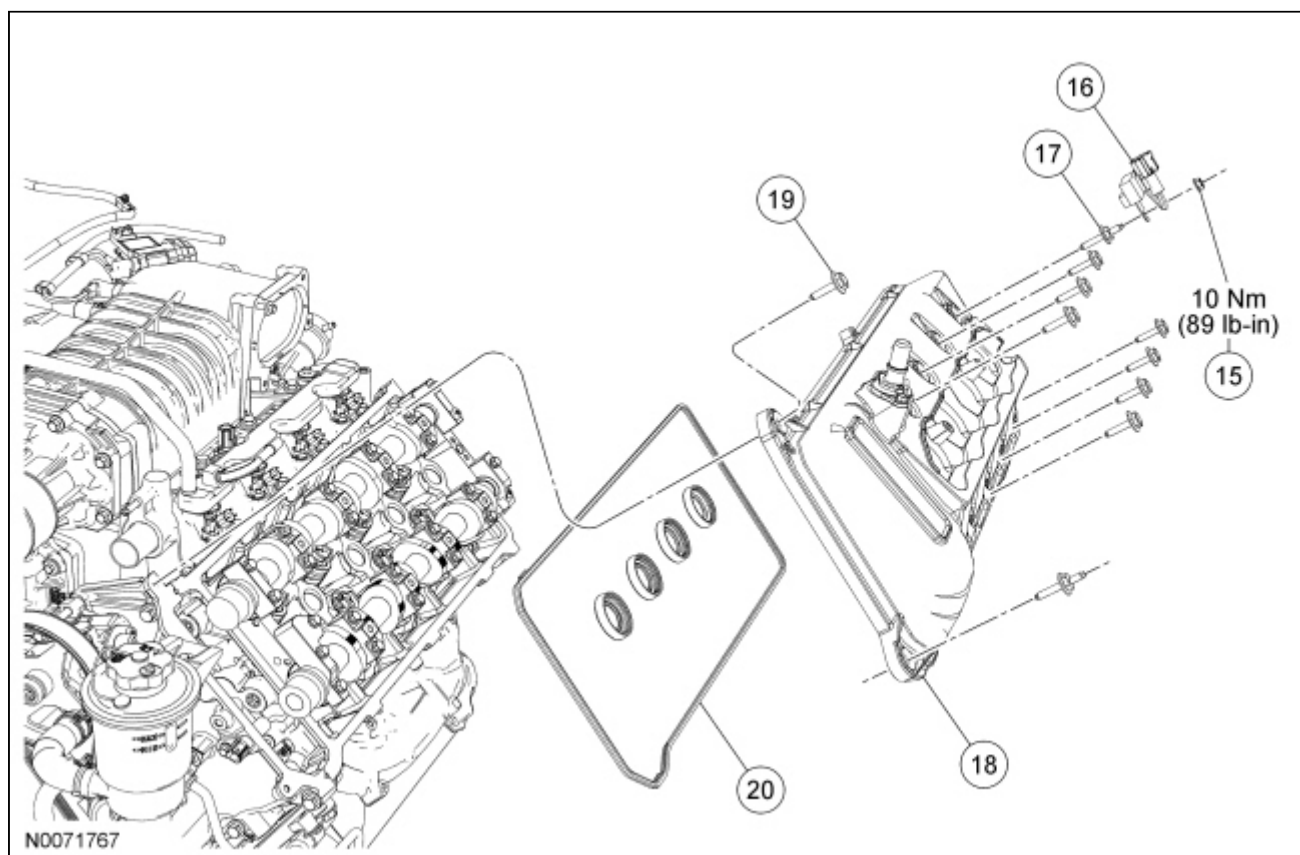

Item	Part Number	Description
15	W520111	LH radio interference capacitor nut
16	18801	LH radio interference capacitor
17	W708442	LH valve cover stud bolt (2 required)

18	6A505	LH valve cover
19	W708441	LH valve cover bolt (8 required)
20	6584	LH valve cover gasket

## Removal

1. Release the fuel system pressure. For additional information, refer to [Section 310-00](#).
2. Disconnect the battery ground cable. For additional information, refer to [Section 414-01](#).
3. Remove the 4 nuts and the strut tower cross brace.

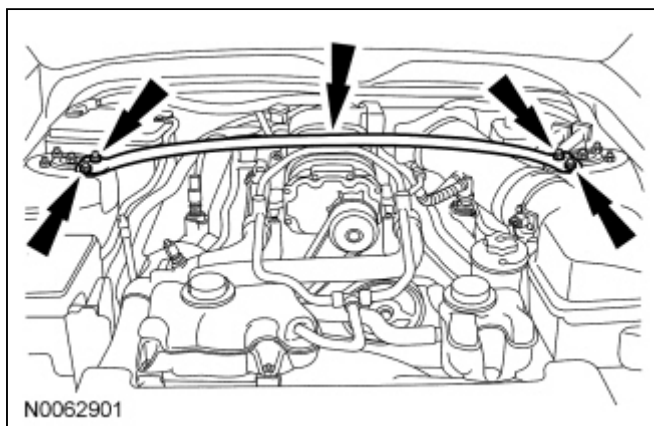

4. Remove the power brake booster. For additional information, refer to [Section 206-07](#).
5. Remove the Air Cleaner (ACL) assembly and [ACL](#) outlet pipe. For additional information, refer to [Section 303-12](#).
6. Remove the LH ignition coils. For additional information, refer to [Section 303-07C](#).
7. Disconnect the Throttle Position (TP) sensor electrical connector.
8. Disconnect the electronic throttle control electrical connector.
9. Disconnect the brake booster vacuum hose from the Throttle Body (TB) spacer.
10. Disconnect the Evaporative Emission (EVAP) hose from the [TB](#) spacer.
11. Remove the 4 bolts and the [TB](#) and spacer assembly.
  - Discard the gasket.
12. Disconnect the 4 LH fuel injector electrical connectors.
13. Disconnect the fuel supply tube. For additional information, refer to [Section 310-00](#).
14. Remove the nut and the LH radio interference capacitor.
15. Disconnect the Camshaft Position (CMP) sensor electrical connector.
16. Remove the 2 power steering reservoir bracket bolts and position the reservoir aside.
17. Detach the 3 wiring harness retainers from the LH valve cover studs.
18. Remove the bolt and position the oil level indicator tube aside.
19. Remove the 8 bolts, 2 stud bolts and LH valve cover.

- Remove and discard the gaskets.
- **NOTICE:** Do not use metal scrapers, wire brushes, power abrasive discs or other abrasive means to clean the sealing surfaces. These tools cause scratches and gouges which make leak paths. Use a plastic scraping tool to remove all traces of old sealant.

Clean the mating surfaces with silicone gasket remover and metal surface prep. Follow the directions on the packaging.

- Inspect the mating surfaces.

## Installation

1. Install new gaskets. Make sure the gaskets are correctly seated on the valve cover.

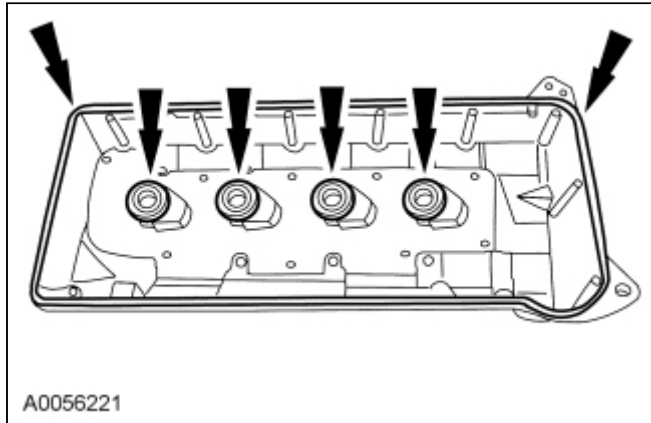

2. **NOTE:** If the valve cover is not secured within 4 minutes, the sealant must be removed and the sealing area cleaned with metal surface prep. Allow to dry until there is no sign of wetness, or 4 minutes, whichever is longer. Failure to follow this procedure can result in future oil leakage.

Apply a bead of silicone gasket and sealant in 2 places where the engine front cover meets the cylinder head.

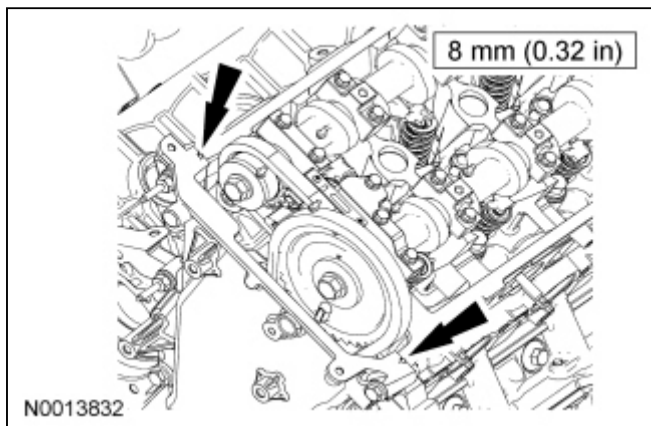

3. Install the RH valve cover, the 8 bolts and 2 stud bolts.
  - Tighten in the sequence shown to 10 Nm (89 lb-in).

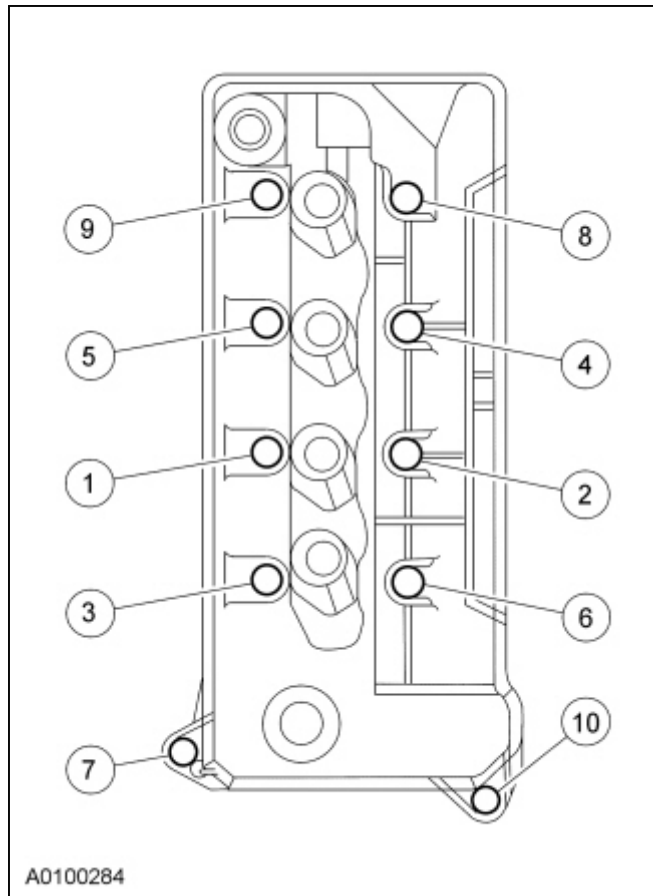

4. Position the oil level indicator tube and install the bolt.
  - Tighten to 10 Nm (89 lb-in).
5. Attach the 3 wiring harness retainers to the LH valve cover studs.
6. Position the power steering reservoir and install the 2 power steering reservoir bracket bolts.
  - Tighten to 25 Nm (18 lb-ft).
7. Connect the [CMP](#) sensor electrical connector.
8. Install the LH radio interference capacitor and nut.
  - Tighten to 10 Nm (89 lb-in).
9. Connect the fuel supply tube. For additional information, refer to [Section 310-00](#).
10. Connect the 4 LH fuel injector electrical connectors.
11. Using a new gasket, install the [TB](#) and spacer assembly and the 4 bolts.
  - Tighten to 10 Nm (89 lb-in).
12. Connect the [EVAP](#) hose to the [TB](#) spacer.
13. Connect the brake booster vacuum hose to the TB spacer.
14. Connect the electronic throttle control electrical connector.
15. Connect the [TP](#) sensor electrical connector.
16. Install the LH ignition coils. For additional information, refer to [Section 303-07C](#).
17. Install the [ACL](#) assembly and [ACL](#) outlet pipe. For additional information, refer to [Section 303-12](#).

18. Install the power brake booster. For additional information, refer to [Section 206-07](#).
19. Install the 4 nuts and the strut tower cross brace.
  - Tighten to 35 Nm (26 lb-ft).

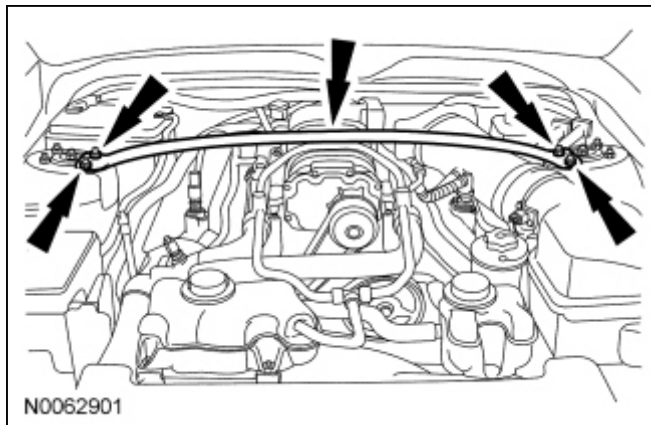

20. Connect the battery ground cable. For additional information, refer to [Section 414-01](#).
-